

Flatgripper SmCo

Permanent Magnet

4049 06 ... 32

Flatgripper with threaded bush

Flatgripper magnet with a SmCo magnet in a steel housing.
 The metallic housing increases the adhesive force of the permanent magnet.
 The maximum adhesive force of this magnetic system is achieved when it is placed over the entire surface on a metal base.
 This series of gripper magnets is designed with a threaded bushing with an internal thread.
 The maximum operating temperature for samarium-cobalt magnets is 200°C

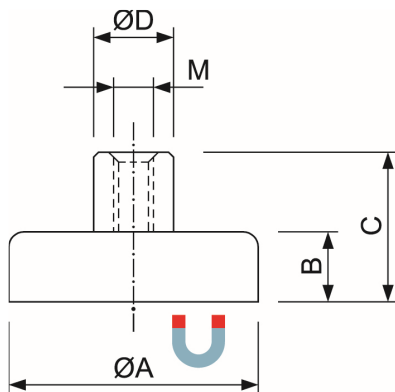
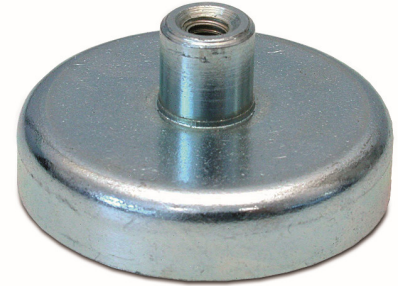

Benefits at a glance

- age-free
- Adhesive power is retained indefinitely
- Limitation of spatial effect to the magnetic field
- Rubber sleeves can be used to prevent slipping on a smooth surface
- high bond strength and high temperature with small size

Special designs or other magnetic materials are possible on request

Part number	Dimensions (mm)				Thread (M)	Holding power (N)	Weight (g)	Temperature (°C)
	ØA	B	C	ØD				
4049 06	6	4,5	11,5	6	M3	5	2	200
4049 08	8	4,5	11,5	6	M3	11	3	200
4049 10	10	4,5	11,5	6	M3	20	4	200
4049 13	13	4,5	11,5	6	M3	40	6	200
4049 16	16	4,5	11,5	6	M4	60	7	200
4049 20	20	6	13	8	M4	90	16	200
4049 25	25	7	14	8	M4	150	28	200
4049 32	32	7	15	10	M5	220	47	200

Changes, omissions, errors in relation to the products reserved. Similar pictures. All rights belong to the respective rights holders. The adhesive forces have been determined on a ground plate (material St37) with a thickness of 10mm when the magnet is pulled off vertically (1kg approximately 10N). Deviations of up to -10% of the specified values are possible.