

Rod gripper SmCo

Permanent Magnet

4011 06 ... 32

Rod gripper in brass housing

Rod gripper with a samarium-cobalt magnet in a brass housing with a fitting tolerance, shortened to measure C
 The maximum adhesive force is achieved when the entire surface is applied to a metal substrate.
 This rod gripper has no thread and is therefore usually glued or pressed in.
 The maximum operating temperature is 200°C.

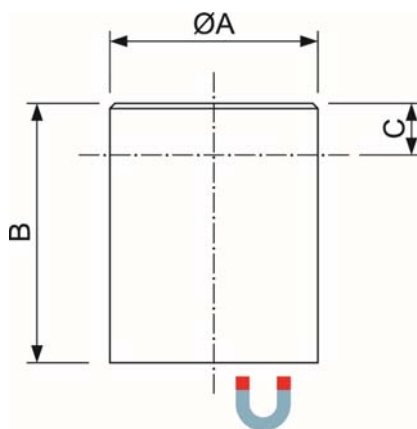

Benefits at a glance

- age-free
- Adhesive power is retained indefinitely
- Limitation of spatial effect to the magnetic field
- high bond strength and small size

Special designs or other magnetic materials are possible on request

Part number	Dimensions (mm)				Holding power (N)	Weight (g)	Temperature (°C)
	Ø A h6	B	C	D			
4011 06	6	20	10	1,5	8	4,5	200
4011 08	8	20	10	1,5	22	8	200
4011 10	10	20	8	2	40	1205	200
4011 13	13	20	6	2.5	60	20	200
4011 16	16	20	2	3	125	32	200
4011 20	20	25	5	4	250	60	200
4011 25	25	35	7	5	400	135	200
4011 32	32	40	4	6	600	250	200

Changes, omissions, errors in relation to the products reserved. Similar pictures. All rights belong to the respective rights holders. The adhesive forces have been determined on a ground plate (material St37) with a thickness of 10mm when the magnet is pulled off vertically (1kg approximately 10N). Deviations of up to -10% of the specified values are possible. When installing the bar gripper in iron, the adhesive force is reduced by approx. 15% due to magnetic short circuits. In order to avoid this, a distance D from the brass casing of the bar gripper to the iron must be maintained.